



AudiaEXPO-D is a digital output expander for Audia®, the benchmark in digital audio systems for demanding professional sound installations. AudiaEXPO-D accepts eight digital audio input signals via CobraNet™ and provides eight channels of digital audio output. AudiaEXPO-D can simply add outputs to a centralized system, or it can extend system boundaries by providing outputs in remote locations. AudiaEXPO-D is represented as a block in Audia software, for easy inclusion into any system design. AudiaEXPO-D may also be used to provide outputs from other CobraNet compliant systems or devices.

FEATURES

- 8 channels of digital audio input via CobraNet
- 4 AES3 digital outputs on XLR (xfmr coupled)
- 2 SPDIF outputs (available channels 1-2 & 3-4)
- 2 TOSLINK outputs (available channels 5-6 & 7-8)
- Word Clock output on BNC connector
- rotary encoder with LCD for programming/setup
- logic inputs for recalling preset configurations
- included as block in AUDIA system design software
- may be used with any CobraNet compliant system
- **CE** marked and **UL** listed power source
- covered by Biamp Systems' five-year warranty

ARCHITECTS & ENGINEERS SPECIFICATION

The Digital Output Expander shall provide eight channels of digital audio input via CobraNet, on two rear panel RJ45 connectors. Four pairs of AES3 transformer coupled digital audio outputs shall be provided on XLR connectors. Two of these pairs shall be available also as SPDIF outputs on RCA connectors, and the other two pairs shall be available also as TOSLINK outputs. A word clock output shall be provided on BNC connector. A rotary encoder and LCD screen shall be provided on the front panel for programming and setup. Logic Inputs shall be provided for recalling preset configurations.

The Digital Output Expander shall be represented as a functional block within Audia® software, for easy inclusion into system designs. The Digital Output Expander shall also be capable of providing digital audio outputs from other CobraNet compliant systems or devices. The Output Expander shall be CE marked, include a UL listed power source, and carry a five-year warranty.

The Digital Output Expander shall be AudiaEXPO-D.

AudiaEXPO-D SPECIFICATIONS

Sample Rate (determined by CobraNet™):	48/96kHz	CobraNet I/O:	100Mb ethernet
Bit Resolution (determined by CobraNet™):	up to 24 bits	Power Consumption (115/230VAC 50/60Hz):	< 12 watts
Audio Output Signal Characteristics / Connectors:		Dimensions:	
AES3 compliant, transformer coupled	XLR	height	1.75 inches (44.5mm)
SPDIF compliant, single ended, AC coupled	RCA	width	19 inches (483mm)
TOSLINK compliant	Optical	depth	5.75 inches (146mm)
Clock Output Signal Characteristics / Connector:		Weight:	4.3 lbs. (2kg)
single ended, TTL compatible	BNC		
Logic Input Signal Characteristics:	TTL or contact-closure		

AudiaEXPO-D REAR PANEL DIAGRAM

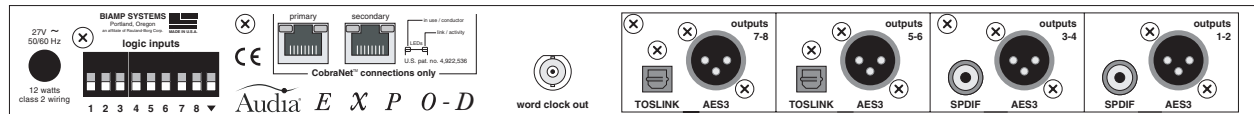

AudiaEXPO-D BLOCK DIAGRAM

